

Trocen TROSIL[®], TROSILTECH[®]

Superior Acoustic Insulation

Construction

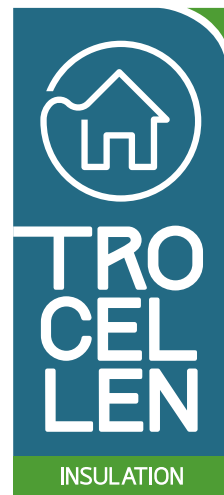

Trosil®

Sound insulation of new generation, against impact sound, manufactured by **TROCELLEN** for comfortable and quiet living. Produced using soft cross-linked polyolefin foam offering excellent mechanical strength as well as sound and thermal insulation.

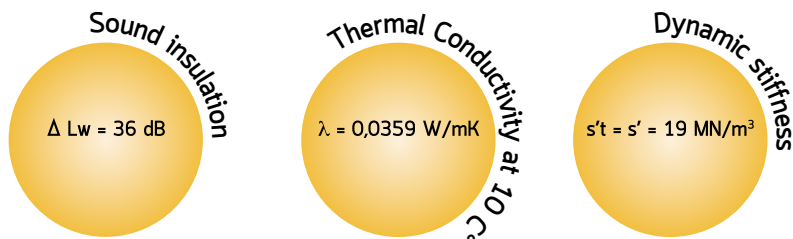

Trosil 10 mm
Measurements with concrete mortar 180 kg/m²

- Flexible and elastic
- Light and waterproof
- High mechanical strength
- Mould and insect resistant
- Non-rotting
- Easy to install
- CFC-free



ITEM SPECIFICATIONS

TROSIL 4 mm

Chemically cross-linked closed cell polyolefin foam, CFC-free.
TROSIL 4 mm thick, density 30 kg/m³
Certified sound insulation $\Delta L_w = 28 \text{ dB}$
Apparent dynamic stiffness $s't = s' = 73 \text{ MN/m}^3$.

TROSIL 5 mm

Chemically cross-linked closed cell polyolefin foam, CFC-free.
TROSIL 5 mm thick, density 30 kg/m³
Certified sound insulation $\Delta L_w = 28 \text{ dB}$
Apparent dynamic stiffness $s't = s' = 52 \text{ MN/m}^3$.

TROSIL 10 mm

Chemically cross-linked closed cell polyolefin foam, CFC-free.
TROSIL 10 mm thick (available also battened), density 30 kg/m³
Certified sound insulation $\Delta L_w = 36 \text{ dB}$
Apparent dynamic stiffness $s't = s' = 19 \text{ MN/m}^3$.

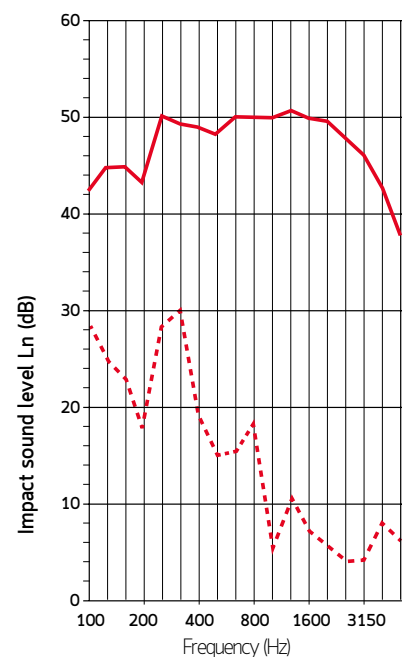

— Bare floor (Ln0) - - - Floor with covering (Ln)

IMPACT SOUND INSULATION

Test Report n. 0040-B/DC/ACU/05 del
18/05/2005



DYNAMIC STIFFNESS

Dynamic stiffness is the elastic strain capacity of a material when subjected to a dynamic stress, i.e. its capacity to function as “sound proofing against the impact sound”.

If used for floating floors, the dynamic stiffness per surface unit is expressed as MN/m^3 . The lower a material’s dynamic stiffness, the greater its sound proofing performance.

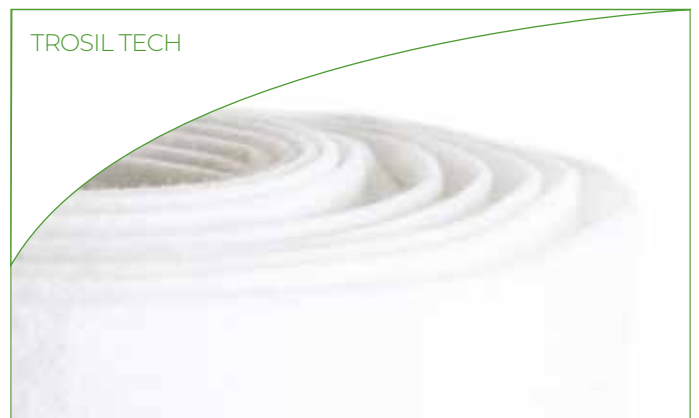

Trosil Tech®

Sound insulation of new generation against impact sound, manufactured by **TROCELLEN** for comfortable and quiet living. Produced using soft cross-linked polyolefin polymer foam laminated to non-woven polyester fiber, with excellent dynamic stiffness.

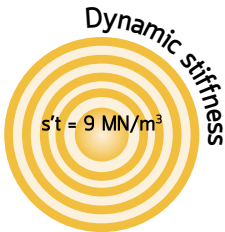
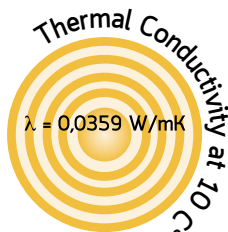
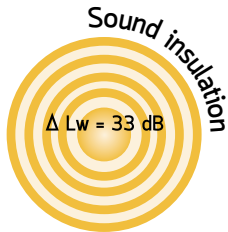

Flexible and elastic

- Light and waterproof
- High mechanical strength
- Mould and insect resistant
- Non-rotting
- Easy to install
- CFC-free

ITEM SPECIFICATIONS

TROSIL TECH 10 mm

Chemically cross-linked closed cell polyolefin foam, CFC-free.

TROSIL TECH density 30 kg/m³, laminated with non-woven polyester fiber, total thickness 10 mm, battened.

Certified sound insulation $\Delta L_w = 33$ dB

Apparent dynamic stiffness $s't = 9$ MN/m³

Dynamic Stiffness $s' = 20$ MN/m³.



(Rapporto di prova n. 194278 del 18/03/2005) segue - foglio n. 5 di 5

Risultati della prova.

Massa della piastra oscillante	8,162 kg
Massa dell'accelerometro	0,018 kg
Massa Totale	8,180 kg
Massa superficiale totale "m"	204,2 kg/m ²
Modalità di eccitazione della piastra di carico	Segnale sinusoidale
Grandezza misurata	Accelerazione

Prova	Spessore sotto carico	Peso	Frequenza di risonanza "f"	Rigidità dinamica apparente "s'i"	Rigidità dinamica apparente media "s'i"
[n.]	[mm]	[g]	[Hz]	[MN/m ³]	[MN/m ³]
1	10	16,6	34	9	9
2	10	16,3	34	9	
3	10	16,1	33	9	
4	10	16,8	33	9	
5	10	17,5	34	19	

RIGIDITÀ DINAMICA

Rapporto di prova n. 194278 del 18/03/2005

Il Responsabile del Laboratorio di Acustica e Vibrazioni (Gen. On. Ing. Andrea Bruschini) Il Presidente o l'Amministratore Delegato (Dot. Ing. Vincenzo Tommi)

TECHNICAL DATA

TECHNICAL CHARACTERISTICS	NORM	UNIT	TROSIL	TROSIL TECH
Description			Chemically cross-linked PE foam	Chemically cross-linked PE foam laminated with polyester fiber
Density	EN ISO 845	kg/m ³	30	30*
Thickness	EN ISO 1923	mm	4 - 5 - 10	10
Colour	BASE Spec.	-	beige	PE beige - fiber white
Roll size		m	thickness: 4 mm: 1,50x50 - 5 mm: 1,50x50 10 mm: 1,50x40 - 10 mm (battened): 1,50x25	1,50x25
Compression stress strength	EN ISO 3386/1	kPa	10%: 13,6 - 25%: 31,6 - 50%: 89,9	10%: 2,27 - 25%: 8,77 50%: 34,18
Water absorption after 28 days	ISO 2896	Vol. %	<3	<3*
Dimensional stability (< 5%)	ISO 2796	°C	75	85
Thermal conductivity coefficient at 10 °C (λ-value)	EN 12667	W/mK kcal/mh°C	0,0359 0,0317	0,0359* 0,0317*
Impact sound insulation ΔL_w (mortar 180 kg/m ²)	EN ISO 140/6-8 EN ISO 717/2	dB	thickness: 4 mm: 28 - 5 mm: 28 - 10 mm: 36	thickness 10 mm: 33
Dynamic stiffness $s't$	EN 29052-1	MN/m ³	thickness: 4 mm: 73 ($s't = s'$) 5 mm: 52 ($s't = s'$) - 10 mm: 19 ($s't = s'$)	thickness 10 mm: 9

The information contained herein is based on our experiences. They are not legally guaranteed and are indicative only. It is up to designers and users to decide whether or not the product is suitable for its intended use. Also assuming liability arising from the use of the products mentioned. Trocellen Italia SpA reserves the right at any time to make changes to the packaging, size and colour, without notice, due to business needs.

* Values for PE foam

INSTALLATION INSTRUCTIONS

TROSIL and **TROSIL TECH** must be installed using the “floating floor” technique, preparing a foundation of light-weight concrete to cover all pipes.

Clean thoroughly and position **TROSIL** or **TROSIL TECH** over the full surface. Take care to overlap the the rolls at least 5 cm and to splice tightly with the adhesive tape Join Band, in order to avoid creating “sound bridges”.

For non-battened **TROSIL** thicker than 5 mm, to prevent the penetration of sand or mortar, match perfectly the rolls and use the adhesive tape Join Band.

TROSIL TECH must be positioned with the polyester face down and the joints covered with the adhesive tape Join Band. Exceeding material can be cut after the floor has been laid, if in direct contact with the vertical walls.

The reinforced concrete (at least 5 cm thick) is laid on top of **TROSIL** or **TROSIL TECH**. Cover the sides of the wall with N-Band to avoid sound-bridges, so that the reinforced concrete floor does not have direct contact with the structural floors or walls.

Alternatively, it is possible to use P-Band, pre-engraved at 50 mm, to facilitate the installation at “L” and reinforced with TNT to prevent breakage.

Exceeding material can be cut after the floor has been laid and prior to fitting the skirting boards.

Before the installation of skirting boards it is advisable to apply our specific tape with an uncoupling function. Then trim the excess, sealing the gaps with a little silicon.

We suggest users to consult the guidelines on the Anit-laying floating floors.

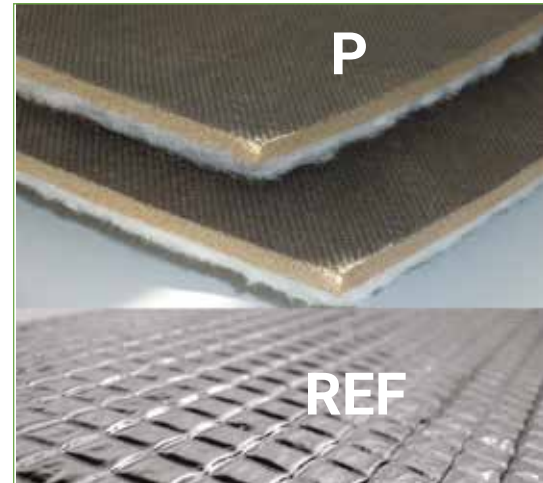
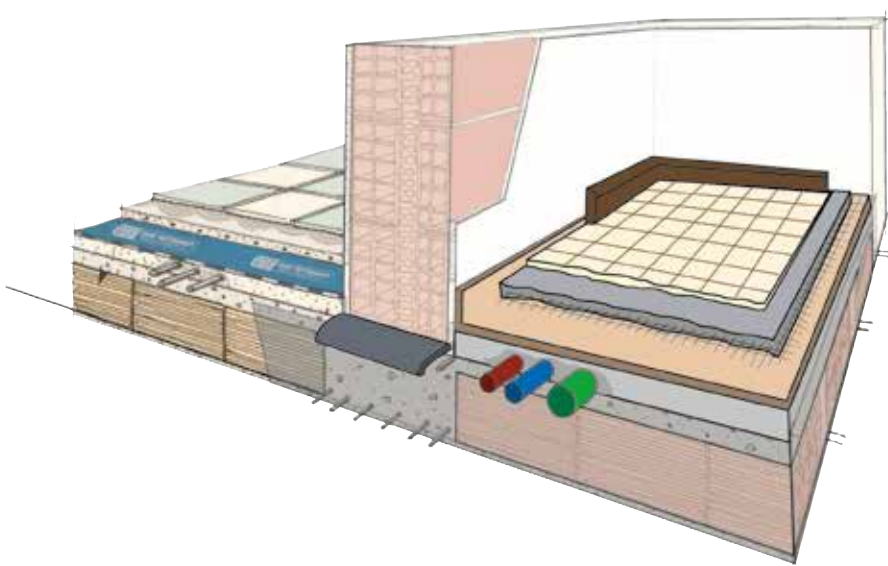

VARIANT P

PP fabric coated for extra protection during the installation of the product

VARIANT REF

Reflective film-coated PET, for improving the thermal insulation product, for example, underfloor heating systems



INTERNATIONAL LOCATIONS

Lead Plant

TROCELLEN Italia S.p.A.

Sales office
Via Dante, 3
20867 Caponago (MB), Italy
Ph. +39 02 959 621
Fax +39 02 959 62 235

Polifoam Plastic Processing Co. Ltd

Táblás u. 32
1097 Budapest, Hungary
Ph. +36 1 347 98 00
Fax +36 1 280 67 08

TROCELLEN GmbH

Mülheimer Straße 26
53840 Troisdorf, Germany
Ph. +49 2241 2549000
Fax +49 2241 2549099

TROCELLEN S.E.A. Sdn Bhd

Lot 2213, Kg. Batu 9 Kebun Baru,
Jalan Kasawari
42500 Telok Panglima Garang
Selangor Darul Ehsan, Malaysia
Ph. +60 3 3122 1213
Fax +60 3 3122 1211

TROCELLEN Ibérica S.A.

C/Avila, s/n
28804 Alcalá de Henares, Spain
Ph. +34 91 885 55 00
Fax +34 91 885 55 01

TROCELLEN France

Bureau de vente
2 rue de Commères,
Immeuble les Peupliers
F-78310 Coignères, France
Ph. +33 (0) 130 85 93 40

insulation@trocellen.com

TROCELLEN*

Trocellen is a multinational company owned by Furukawa Electric Co. Ltd, internationally renowned for the design and manufacture of cross-linked polyolefin foam.

Through its different Business Units, the company is able to meet the specific needs of the market with a wide range of products and solutions.

It manufactures both semi-finished and finished products. The Trocellen products stand out for their manufacturing processes and the many industrial sectors in which they can be used: Insulation, automotive, footwear, sport and leisure, adhesive tapes and packaging. Trocellen makes safety a lifestyle and turns safety into a lifestyle.

Insulation Business Unit

The Insulation Business Unit mainly specialises in Sound and Thermal insulation for the building industry. The goal is to create comfortable environments for people or rather to "help people live better!".

*Trocellen is the member of Furukawa Group.



FOLLOW US
ON TWITTER



CONTACT US
ON LINKEDIN



www.trocellen.com

Download Trocellen App
from the Official Website

